

1	AXLE, VERTICAL	.625-18x4.35	1
2	BUSHING	TW-19	3
3	COTTER PIN ZINC	.11X1.5COTTERPIN	2
4	SPACER	BSP4	2
5	BOLT	AN3-6	2
6	WASHER	AN960-10	6
7	NYLON WASHER	.750X.443X.062WASHER	2
8	WING, TAIL WHEEL	T-03**See Note on Alternate**	2
9	CASTLE NUT	AN310-3	2
10	COTTER PIN ZINC	.062X.50COTTERPIN	2
11	SHCS (AXLE)	.50-13X4.50SHCS	1
12	FORK, 8" TAIL WHEEL	TW-8F	1
13	LOCK NUT	10-24NYLOCK	3
14	BEARING, BALL .625	SKF1623DCTN	2
15	BACK HALF, 4" TW, .625 BRNG	NW40E/.625	1

16	SLEEVE, .625 X .50 X 2 TUBE	T8SL	1
----	-----------------------------	------	---

17	WASHER	.625 SAE	2
18	BASE, TAIL WHEEL	TWBL	1

19	BUSHING, BRZ	TW-4	1
----	--------------	------	---

20	ARM, TAIL WHEEL	T-02	1
----	-----------------	------	---

21	BUSHING BRZ	TW-21	1
----	-------------	-------	---

22	SHCS	.25-20X.50SHCS	1
----	------	----------------	---

23	HEX NUT SLOTTED	.62-18HEXNUT/SLOTTED	2
----	-----------------	----------------------	---

24	TIRE, 9x3.40 4PLY	T9x3.50-4	1
----	-------------------	-----------	---

25	TUBE 4.10/3.50-4	TU4.10/3.50-4	1
----	------------------	---------------	---

26	VALVE HALF, 4" TW, .625 BRNG	NW40E/.625	1
----	------------------------------	------------	---

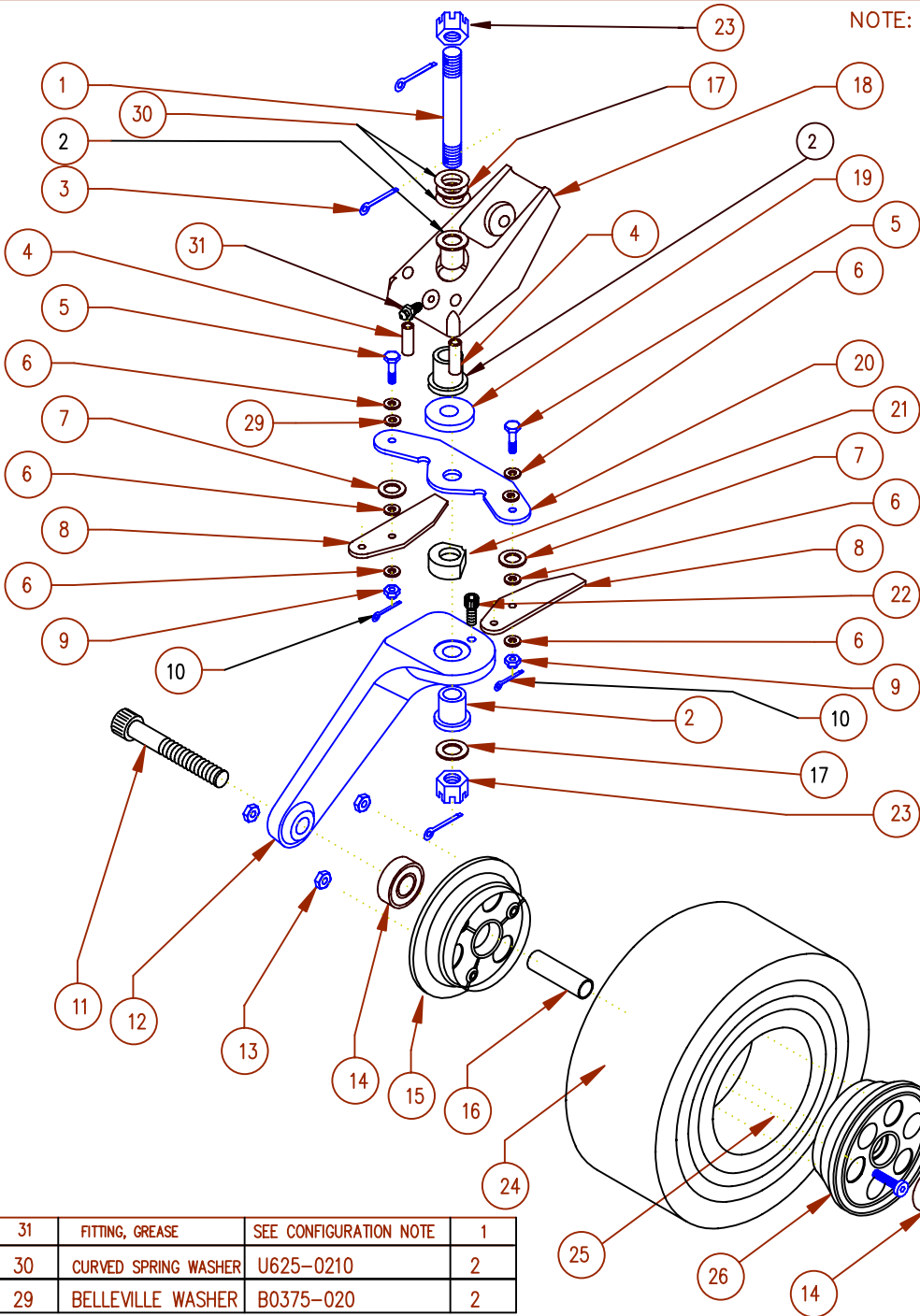

NOTE: Alternate Wing Available to Provide Earlier Steering Release. Part number T-03A Release with Standard T-03 = ±45° Release with T-03A = ±25° T-03A May Be Hand Ground to Angles between ±25° & ±50°

To Set Preload In Vertical Axle #1: Be Certain #30 Springs Are Installed. Seat Upper Nut #23 Fully & Install Cotter Pin. Tighten Lower Nut #23 Slowly until All Freeplay of Springs #30 is Removed and Fork #12 No Longer Rotates Freely. Loosen Lower Nut #23 2-3 Locking Features and Install Cotter Pin. Fork Should Pivot Freely Around Complete Rotation

31	FITTING, GREASE	SEE CONFIGURATION NOTE	1
30	CURVED SPRING WASHER	U625-0210	2
29	BELLEVILLE WASHER	B0375-020	2

NO.	PART NAME	INVENTORY NO.	REQ'D
-----	-----------	---------------	-------